

CHAIRMAN'S CLUB & GRANDVIEW

Luxurious space normally reserved for Sydney's social elite on raceday which transforms into a first-class experience for any event.

With high specification finishes, The Chairman's Club and Grandview is our premium event space that pairs first-class design with sweeping views. Located directly above the winning post on Level 1 in the prestigious Queen Elizabeth II Grandstand and featuring tiered dining facilities, casual lounge areas and a stunning outdoor terrace, it's the perfect venue to make a statement. For a more intimate feel, host your party or next corporate event in the exclusive Directors' Room. The options are endless with these renowned spaces.



VENUE FEATURES

- Luxurious and first-class finishes
- Natural light and sweeping views
- Tiered dining area
- Terrace overlooking the Theatre of the Horse
- Award-winning catering serviced by a commercial kitchen
- Free high density WiFi
- Bars and lounge area
- Carpeted floor
- Three tonne goods lift
- LED screens
- Standard power access, with floor box and pillar power outlets
- Air conditioning
- Amenities
- Limited complimentary parking
- Onsite security

SUITABLE FOR

CEO / Board meetings, celebrations, parties and corporate events.

Chairman's Club Gross Area: 798m²
Grandview Room Gross Area: 574m²
Ceiling Height: 2.75-2.9m

To find out more please contact our

Meetings & Events Team

P | 1300 729 668

E | meetingsandevents@australianurfclub.com.au



LEVEL 1
QUEEN ELIZABETH II
GRANDSTAND

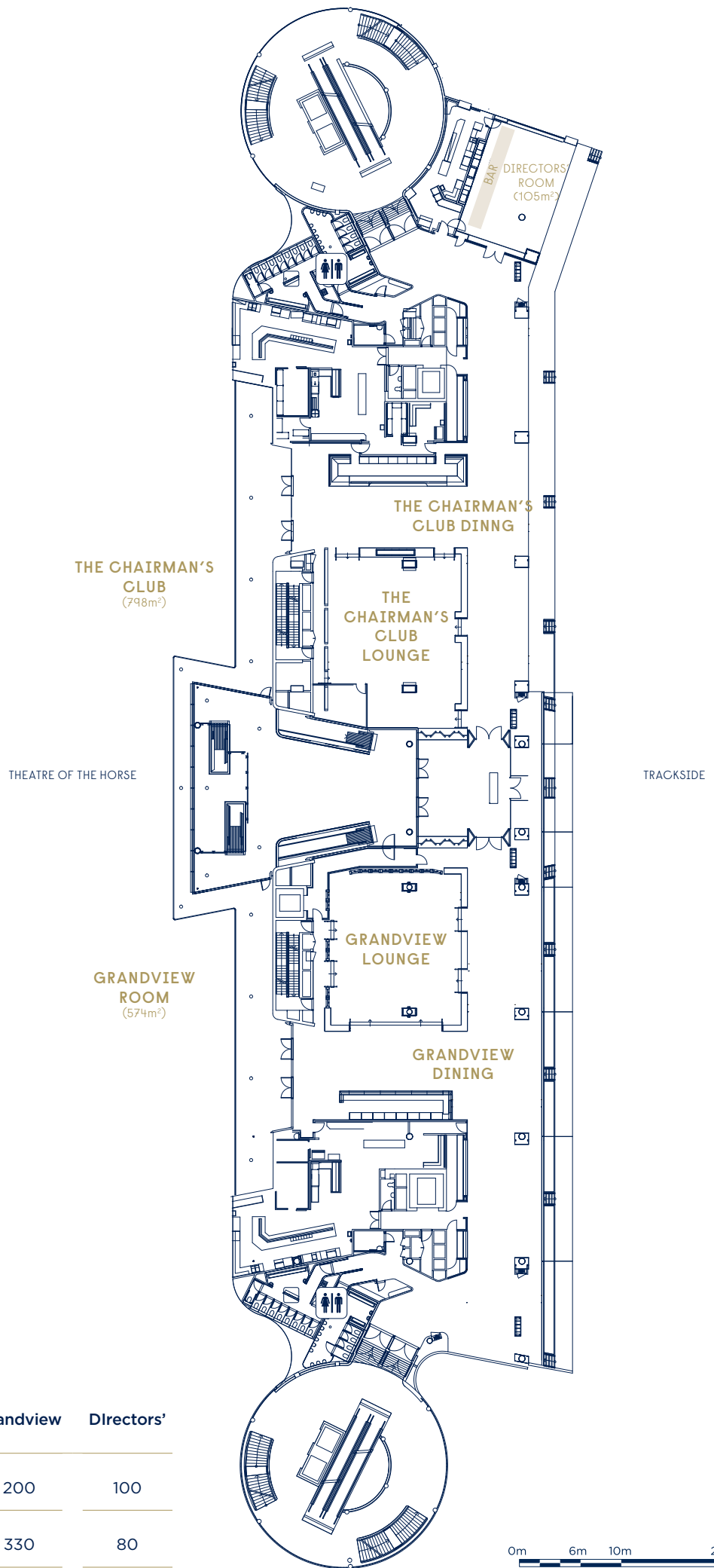

VENUE CAPACITY

Room	The Chairman's Club	Grandview	Directors'
COCKTAIL	200	200	100
BANQUET	350	330	80