

MALT SHOVEL TAPHOUSE

A historic building with a contemporary flavour, this light-filled venue blends seamless indoor and outdoor spaces for the perfect free-flowing celebration.

Located in the historic Octagonal Building, the Malt Shovel Taphouse is our newest venue having undergone an extensive refurbishment to complement our existing venue portfolio. It has been purpose built for cocktail events. With floor-to-ceiling glass doors that open out onto an expansive beautifully manicured lawn, it's ideal for intimate gatherings with loved ones or celebrations with colleagues. The lawns can be dressed to match the style of your event and provides a picture-perfect location to turn an event into an occasion.



VENUE FEATURES

- Seamless indoor and outdoor space
- Free high density WiFi
- Permanent cocktail furniture fixtures with dedicated bar area
- LED screens
- In-built sound system
- Standard power access
- Award-winning catering and service
- Air conditioning
- Limited complimentary parking
- Onsite security

SUITABLE FOR

Celebrations and parties, christmas events, weddings and product launches.

Gross Area: 370m²



To find out more please contact our
Meetings & Events Team
P | 1300 729 668
E | meetingsandevents@australianurfclub.com.au

MALT SHOVEL
TAPHOUSE

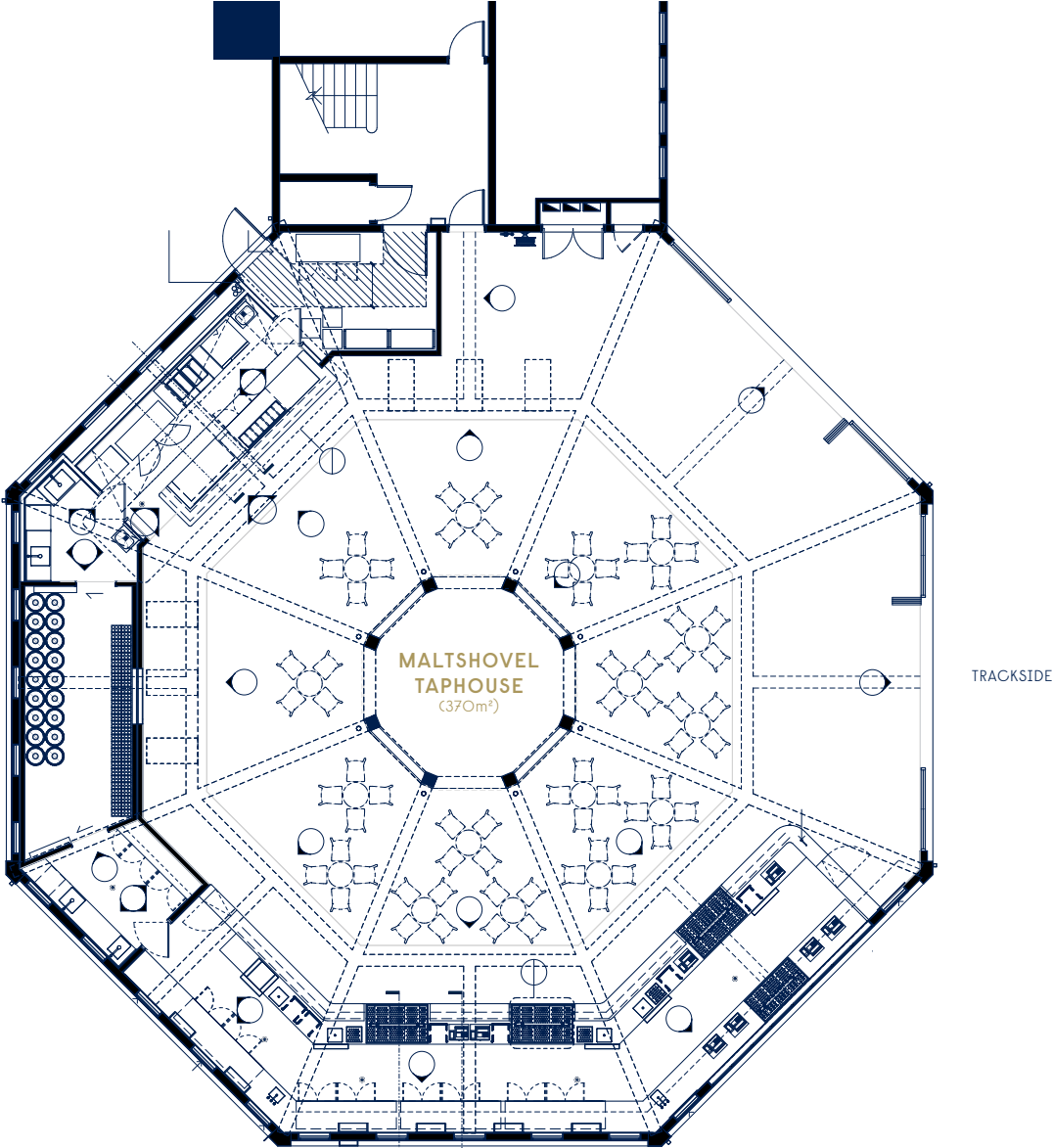

VENUE CAPACITY

110 COCKTAIL

0m 10m 25m 50m